

User Manual

ILUMIPANEL ML



Model ID: ILUMIPANELML

ILUMINARC®

Edition Notes

The Ilumipanel ML User Manual includes a description, safety precautions, installation, programming, operation, and maintenance instructions for the Ilumipanel ML as of the release date of this edition.

Trademarks

ILUMINARC, the Iluminarc logo, and Ilumipanel ML are registered trademarks or trademarks of Chauvet & Sons, LLC (d/b/a Chauvet and Chauvet Lighting) in the United States and other countries. Other company and product names and logos referred to herein may be trademarks of their respective companies.

Copyright Notice

The works of authorship contained in this manual, including, but not limited to, all design, text, and images are owned by Chauvet.

© Copyright 2025 Chauvet & Sons, LLC. All rights reserved.

Electronically published by Chauvet in the United States of America.

Manual Use

Chauvet authorizes its customers to download and print this manual for professional information purposes only. Chauvet expressly prohibits the usage, copy, storage, distribution, modification, or printing of this manual or its content for any other purpose without written consent from Chauvet.

Document Printing

For best results, print this document in color, on letter size paper (8.5 x 11 in), double-sided. If using A4 paper (210 x 297 mm), configure the printer to scale the content accordingly.

Intended Audience

Any person installing, operating, and/or maintaining this product should completely read through the guide that shipped with the product, as well as this manual, before installing, operating, or maintaining this product.

Disclaimer

Chauvet believes that the information contained in this manual is accurate in all respects. However, Chauvet assumes no responsibility and specifically disclaims any and all liability to any party for any loss, damage or disruption caused by any errors or omissions in this document, whether such errors or omissions result from negligence, accident, or any other cause. Chauvet reserves the right to revise the content of this document without any obligation to notify any person or company of such revision, however, Chauvet has no obligation to make, and does not commit to make, any such revisions.

Document Revision

Go to www.iluminarc.com for the latest version.

Revision	Date	Description
5	07/2025	Added power and DMX wiring diagrams, updated technical specifications, formatting.

TABLE OF CONTENTS

1. Before You Begin	1
What Is Included	1
Claims	1
Text Conventions	1
Symbols	1
Safety Notes.....	2
FCC Statement of Compliance	3
Expected LED Lifespan.....	3
2. Introduction	4
Product Overview.....	4
Product Dimensions	5
3. Setup	6
AC Power	6
Power Wiring.....	6
AC Plug	6
DMX Linking.....	7
DMX Wiring	7
DMX Connection	7
Remote Device Management.....	8
Beam-Shaping Filters.....	8
Mounting	9
Orientation.....	9
Rigging	9
Procedure.....	9
4. Operation	10
RDM2go Control	10
Menu Map	10
DMX Configuration.....	11
Control Personalities	11
Starting Address.....	11
Control Channel Assignments and Values.....	11
Preset Colors Chart.....	11
Color Temperature Chart	11
ARC.....	12
SOLID	12
SPECIAL	12
Static Mode Configuration.....	13
Settings Configuration.....	13
Dimmer Speed	13
Color Calibration	13
Color Macro White Balance	13
RGBTOW Mode	13
Universal Calibration	13
Factory Reset.....	13
5. Maintenance.....	14
Product Maintenance	14
6. Technical Specifications	15
Contact Us	16
Warranty & Returns.....	16

1. Before You Begin

What Is Included

- Ilumipanel ML
- Filter frame
- Quick Reference Guide

Claims

Carefully unpack the product immediately and check the container to make sure all the parts are in the package and are in good condition.



If the box or the contents (the product and included accessories) appear damaged from shipping, or show signs of mishandling, notify the carrier immediately, not Chauvet. Failure to report damage to the carrier immediately may invalidate a claim. In addition, keep the box and contents for inspection.

For other issues, such as missing components or parts, damage not related to shipping, or concealed damage, file a claim with Chauvet within 7 days of delivery.

Text Conventions

Convention	Meaning
1–512	A range of values
50/60	A set of values of which only one can be chosen
Settings	A menu option not to be modified
<ENTER>	A key to be pressed on the product's control panel

Symbols

Symbol	Meaning
	Critical installation, configuration, or operation information. Not following these instructions may make the product not work, cause damage to the product, or cause harm to the operator.
	Important installation or configuration information. The product may not function correctly if this information is not used.
	Useful information.



Any reference to data or power connections in this manual assumes the use of IP65- (or higher) rated cables.



The term “DMX” used throughout this manual refers to the USITT DMX512-A digital data transmission protocol.

Connection of the control signal: DMX line

- The product has XLR sockets for DMX input and output.
- Notice: This control circuit is isolated and belongs to the Class 2 data port.

The control circuit has a cumulative leakage current of less than 3.5 mA.

Safety Notes

Read all the following safety notes before working with this product. These notes contain important information about the installation, usage, and maintenance of this product.



This product contains no user-serviceable parts. Any reference to servicing in this User Manual will only apply to properly trained, certified technicians. Do not open the housing or attempt any repairs.



All applicable local codes and regulations apply to proper installation of this product.

- The luminaire is intended for professional use only.
- The luminaire should be positioned so that prolonged staring into the luminaire at a distance closer than 3.3 ft (1 m) is not expected.
- If the external flexible cable or cord of this luminaire is damaged, it shall be replaced by a special cord or cord exclusively available from the manufacturer or its service agent.
- The light source contained in this luminaire shall only be replaced by the manufacturer or its service agent or a similar qualified person.
- **CAUTION:**
 - This product's housing may be hot when operating. Mount this product in a location with adequate ventilation, at least 20 in (50 cm) from adjacent surfaces.
 - When transferring the product from extreme temperature environments, (e.g., cold truck to warm humid ballroom) condensation may form on the internal electronics of the product. To avoid causing a failure, allow the product to fully acclimate to the surrounding environment before connecting it to power.
 - Flashing light is known to trigger epileptic seizures. User must comply with local laws regarding notification of strobe use.
- **ALWAYS:**
 - Disconnect from power before cleaning the product or replacing the fuse.
 - When using an IP67-rated product in an outdoor environment, use IP65- (or higher) rated power and data cable.
 - Replace and secure IP-rated protective covers to all power, data, USB, or other ports when not in use.
 - Use a safety cable when mounting this product overhead.
 - Connect this product to a grounded and protected circuit.
- **DO NOT:**
 - Open this product. It contains no user-serviceable parts.
 - Look at the light source when the product is on.
 - Leave any flammable material within 50 cm of this product while operating or connected to power.
 - Connect this product to a dimmer or rheostat.
 - Operate this product if the housing, lenses, or cables appear damaged.
 - Submerge this product (adhere to standards for the published IP rating). Regular outdoor operation is fine.
 - Permanently install outdoors in locations with extreme environmental conditions. This includes, but is not limited to:
 - Exposure to a marine/saline environment (within 3 miles of a saltwater body of water).
 - Locations where normal temperatures exceed the temperature ranges in this manual.
 - Locations that are prone to flooding or being buried in snow.
 - Other areas where the product will be subject to extreme radiation or caustic substances.
 - **ONLY** use the hanging/mounting bracket to carry this product.
 - The maximum ambient temperature is 113 °F (45 °C). Do not operate this product at higher temperatures.
 - The minimum startup temperature is -4°F (-20°C). Do not start the product at lower temperatures.
 - The minimum ambient temperature is -40°F (-40°C). Do not operate the product at lower temperatures.
 - To eliminate unnecessary wear and improve its lifespan, during periods of non-use completely disconnect the product from power via breaker or by unplugging it.
 - In the event of a serious operating problem, stop using immediately.



If this Chauvet product requires service, contact Chauvet Technical Support.

FCC Statement of Compliance

This device complies with Part 15 Part B of the FCC rules. Operation is subject to the following two conditions:

1. This device may not cause harmful interference, and
2. This device must accept any interference received, including interference that may cause undesired operation.

This equipment has been tested and found to comply with the limits for a Class B digital device, pursuant to Part 15 of the FCC Rules. These limits are designed to provide reasonable protection against harmful interference in a residential installation. This equipment generates uses and can radiate radio frequency energy and, if not installed and used in accordance with the instructions, may cause harmful interference to radio communications. However, there is no guarantee that interference will not occur in a particular installation. If this equipment does cause harmful interference to radio or television reception, which can be determined by turning the equipment off and on, the user is encouraged to try to correct the interference by one or more of the following measures:

- Reorient or relocate the receiving antenna.
- Increase the separation between the equipment and receiver.
- Connect the equipment into an outlet on a circuit different from that to which the receiver is connected.
- Consult the dealer or an experienced radio/TV technician for help.

Any changes or modifications not expressly approved by the party responsible for compliance could void the user's authority to operate the equipment.

Expected LED Lifespan

Over time, use and heat will gradually reduce LED brightness. Clustered LEDs produce more heat than single LEDs, contributing to shorter lifespans if always used at full intensity. The average LED lifespan is 40,000 to 50,000 hours. To extend LED lifespan, maintain proper ventilation around the product, and limit the overall intensity.

2. Introduction

Product Overview

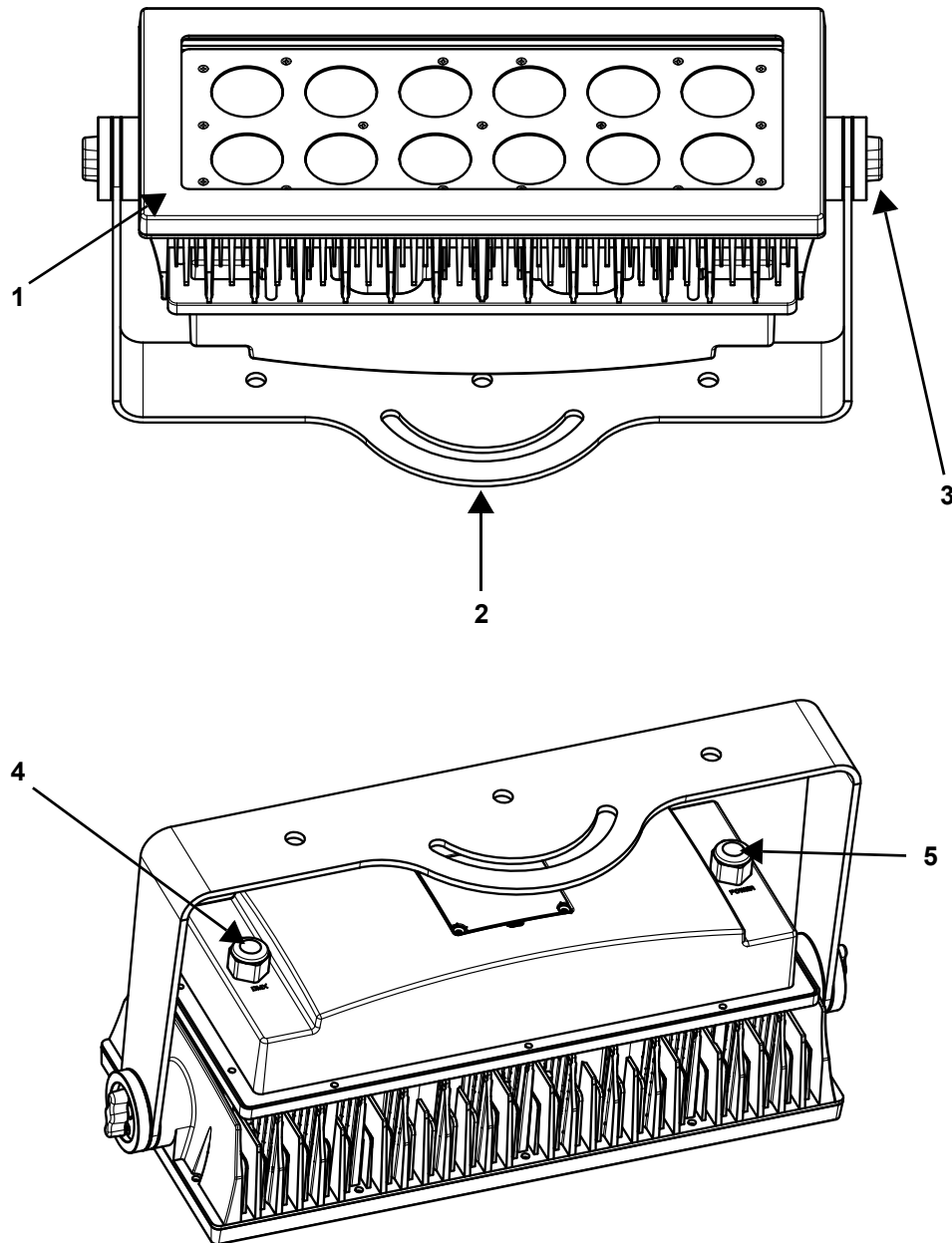

#	Name
1	Filter frame
2	Mounting bracket
3	Position locking pin
4	DMX input
5	Power input

Product Dimensions

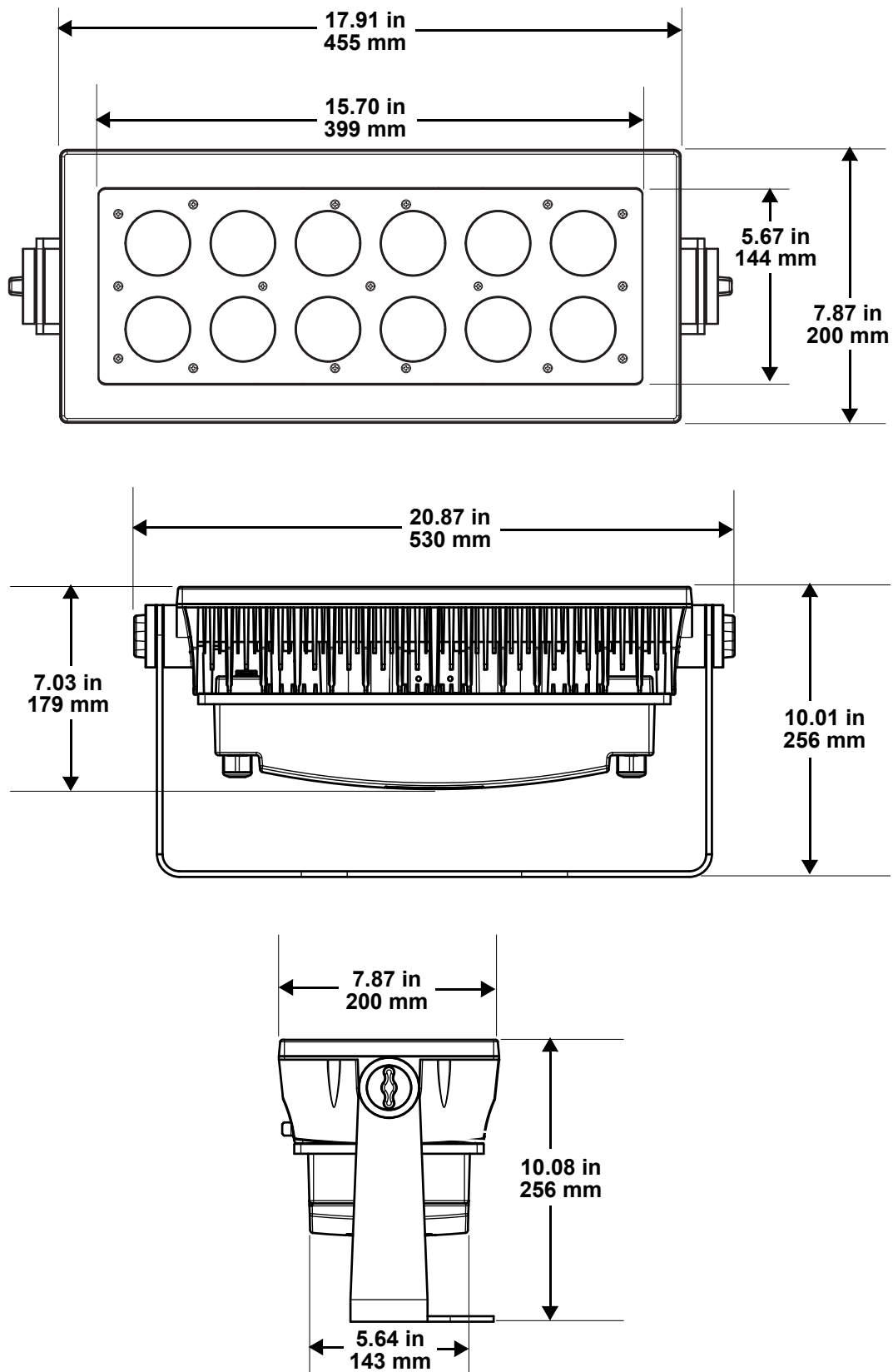

3. Setup

AC Power

The Ilumipanel ML has an auto-ranging power supply, and it can work with an input voltage range of 100 to 277 VAC, 50/60 Hz.

To determine the product's power requirements (circuit breaker, power outlet, and wiring), use the current value listed on the label affixed to the product's back panel, or refer to the product's specifications chart.

The listed current rating indicates the product's average current draw under normal conditions.



- **Always connect the product to a protected circuit (a circuit breaker or fuse). Make sure the product has an appropriate electrical ground to avoid the risk of electrocution or fire.**
- **To eliminate unnecessary wear and improve its lifespan, during periods of non-use completely disconnect the product from power via breaker or by unplugging it.**



Never connect the product to a rheostat (variable resistor) or dimmer circuit, even if the rheostat or dimmer channel serves only as a 0 to 100% switch.

Power Wiring

The Ilumipanel ML comes with a bare-ended power input cord. Use the diagram below and an IP65- (or higher) rated conduit to wire it directly into an IP65- (or higher) rated distribution or junction box.

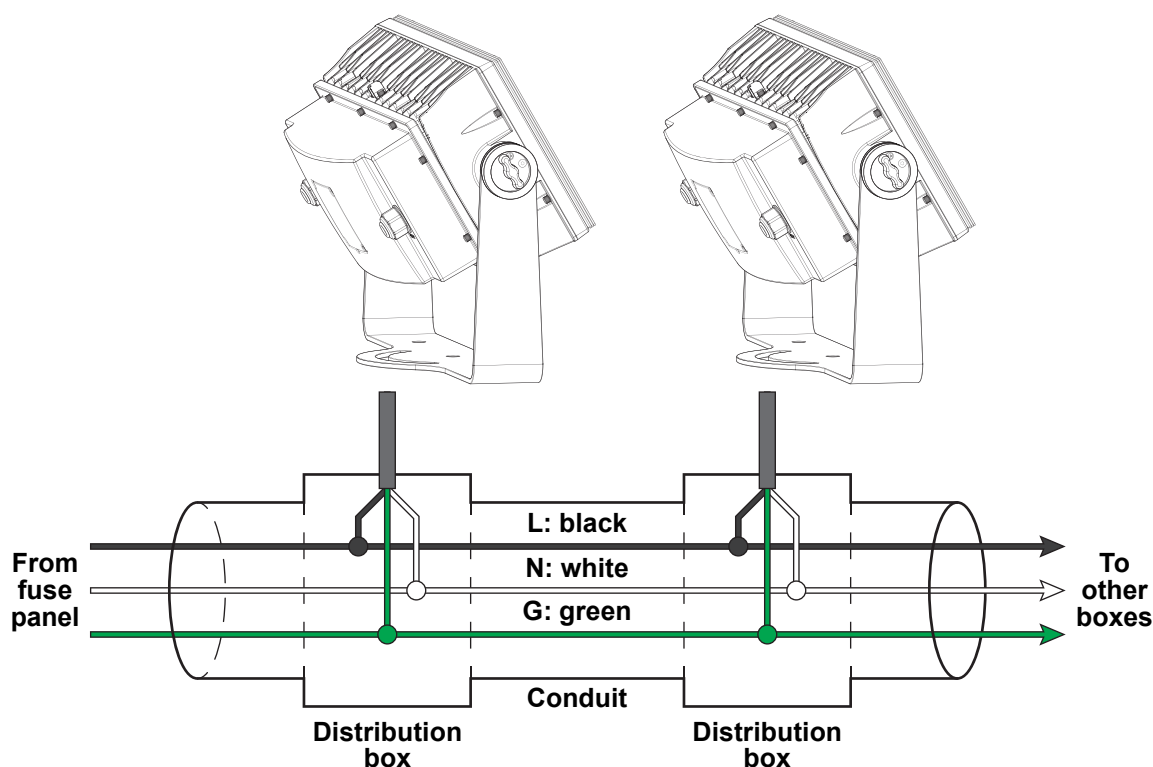

AC Plug

The Ilumipanel ML comes with a bare-ended power input cord. Use the table below to wire a plug.

Connection	Wire (U.S.)	Wire (Europe)	Screw Color
AC Live	Black	Brown	Yellow or Brass
AC Neutral	White	Blue	Silver
AC Ground	Green/Yellow	Green/Yellow	Green

DMX Linking

The Ilumipanel ML will work with a DMX controller using a standard DMX serial connection. A DMX Primer is available from www.iluminarc.com.

DMX Wiring

The Ilumipanel ML provides a DMX-512 connection using bare-ended signal cable. This cable comes connected to the product. Use the diagram below and an IP65- (or higher) rated conduit to wire it directly into a junction box.

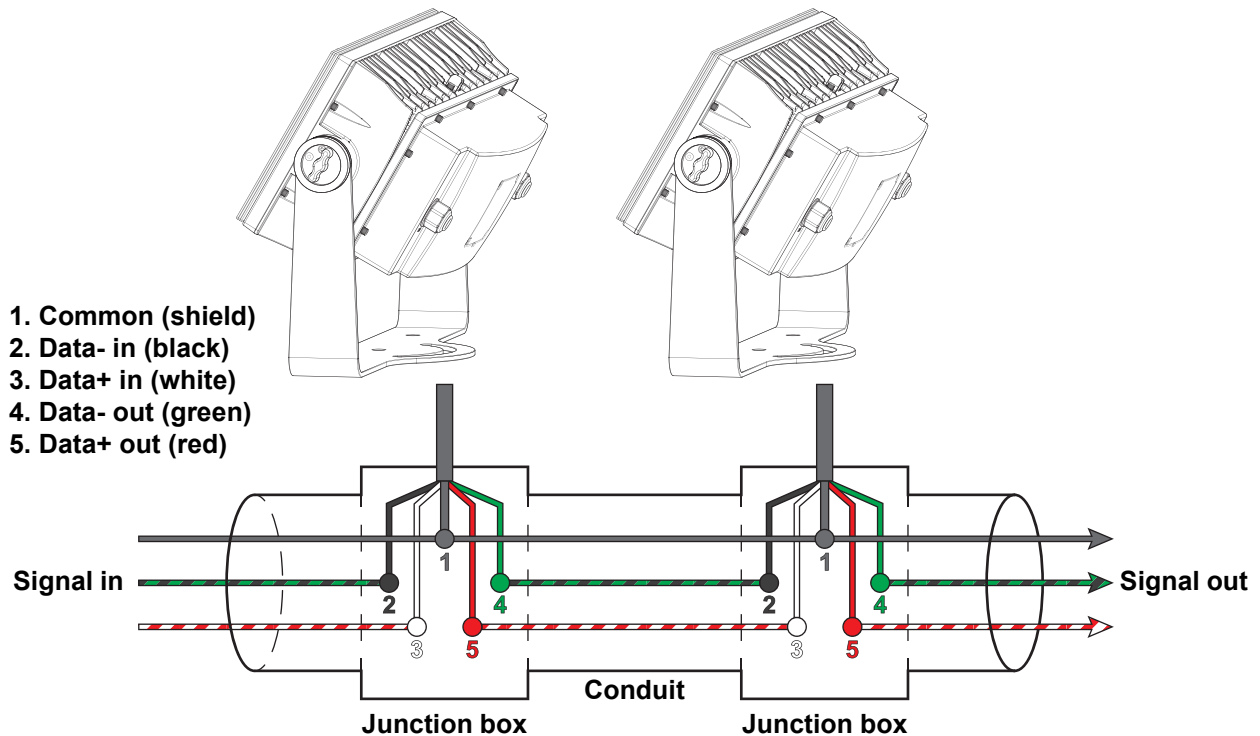

DMX Connection

The Ilumipanel ML provides a DMX-512 connection using bare-ended IP67-rated signal cable. This cable comes connected to the product. Use the diagram below to connect it with an alligator clip adapter.

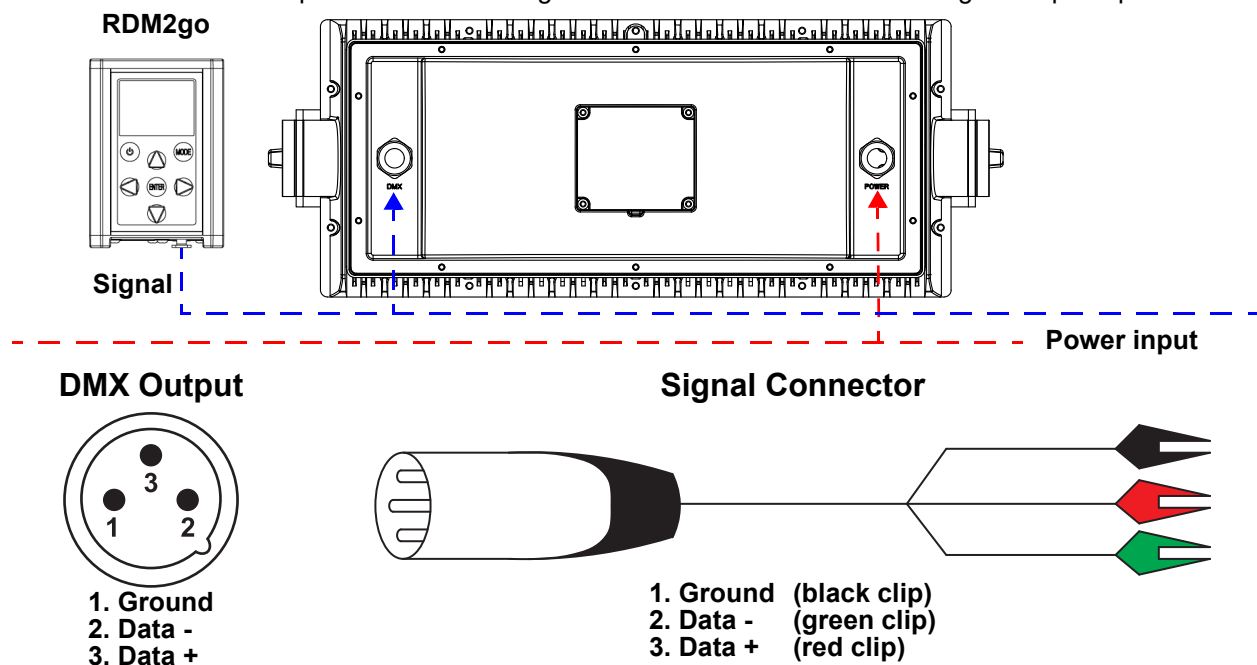

Remote Device Management

Remote Device Management, or RDM, is a standard for allowing DMX-enabled devices to communicate bi-directionally along existing DMX cabling. Check the DMX controller's User Manual or with the manufacturer as not all DMX controllers have this capability. The Ilumipanel ML supports RDM protocol that allows feedback to make changes to menu map options.

Beam-Shaping Filters

The Ilumipanel ML can be used with the medium, wide, very wide, or asymmetrical beam-shaping filters (sold separately).

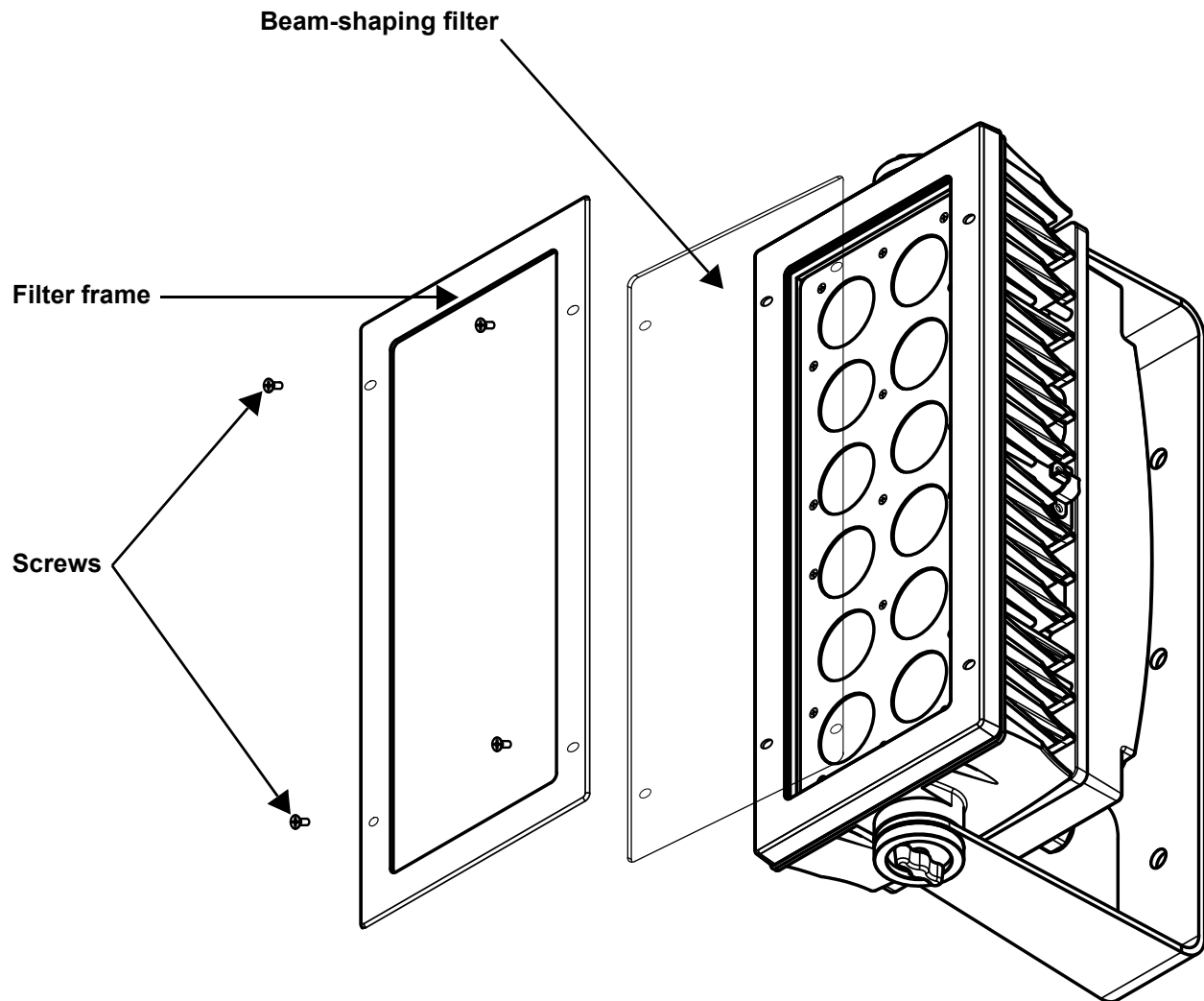

Follow the instructions below to install one of the optional filters:

1. Detach the filter retainer lid by removing the screws attaching it to the fixture.
2. Place the beam-shaping filter on top of the lenses. Ensure the glossy side of the filter is facing OUT.
3. Place the filter frame on top of the beam-shaping filter.
4. Secure the filter and frame in place with the included screws.

Mounting

Before mounting the product, read and follow the safety recommendations indicated in the Safety Notes.

Orientation

Always mount this product in a safe position, making sure there is adequate room for ventilation, configuration, and maintenance.

Rigging

Chauvet recommends using the following general guidelines when mounting this product.

- Before deciding on a location for the product, always make sure there is easy access to the product for maintenance and programming.
- Make sure that the structure or surface onto which the product is being mounted can support the product's weight (see the [Technical Specifications](#)).
- When mounting the product overhead, always use a safety cable. Mount the product securely to a rigging point, whether an elevated platform or a truss.
- When rigging the product onto a truss, use hardware of appropriate weight capacity.

Procedure

The Ilumipanel ML comes with two adjustable brackets that can be secured directly to a mounting surface. Make sure the mounting surface and hardware are capable of supporting the weight of this product. Use at least one mounting point per product.

Mounting Diagram

Overhead Mounting

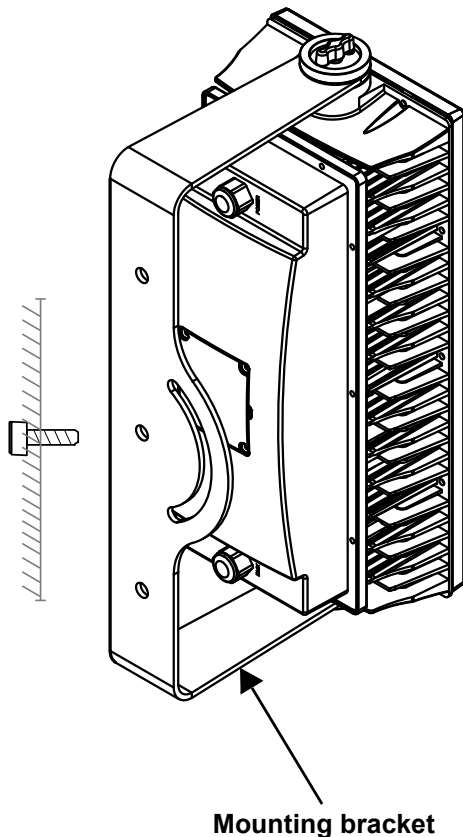

Surface Mounting

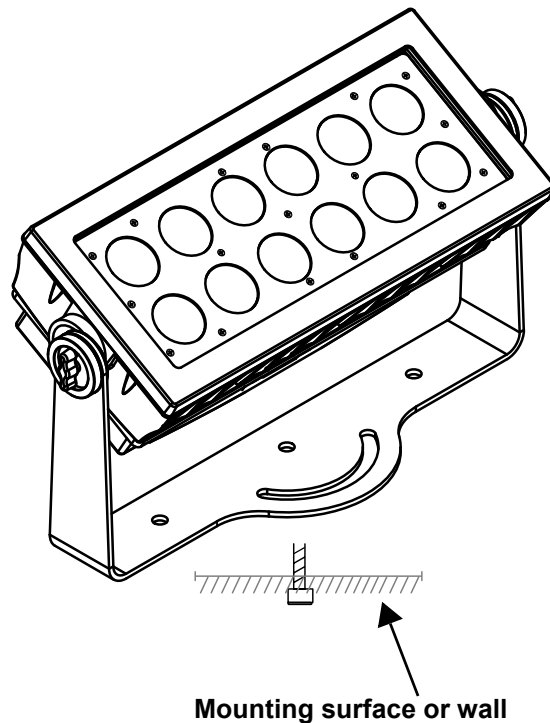

4. Operation

RDM2go Control

The Ilumipanel ML requires an external controller, such as the RDM2go (from Chauvet Professional), to change its configuration.

Menu Map

Refer to the Ilumipanel ML product page on www.iluminarc.com for the latest menu map.

The Ilumicode section of the RDM2go (from Chauvet Professional) is required to access the full menu of options. For more information, download the RDM2go User Manual from www.chauvetprofessional.com.

Main Level	Programming Levels		Description
STATIC	RED GREEN BLUE COOL SOLID STROBE	000–255	Configures the static color and effect
	OFF		Dimmer works in linear mode
DIMMER	DIM1–4		Dimmer works in non-linear mode, from fastest (DIM1) to slowest (DIM4)
	WHITE (1–11)		Determines the white balance for the color macros
CALIB	RGBTOW	000–255	Determines the white balance when RGBTOW is active
	RED GREEN BLUE COOL		
PERSON	ARC1		3-channel: RGB control
	ARC1+D		4-channel: dimmer, RGB control
	ARC2		4-channel: RGBL control
	ARC2+D		5-channel: dimmer, RGBL control
	ARC FULL		8-channel: dimmer, RGB control, preset colors, color temperature, strobe, dimmer speed
	SOLID		1-channel: LED control
	SPECIAL1		15-channel: dimmer, strobe, dimmer speed, RGBL1, RGBL2, RGBL3
	SPECIAL2		9-channel: dimmer, RGBL control, preset colors, color temperature, strobe, dimmer speed
DMX	001–512		Selects DMX address (highest channel restricted to personality chosen)
UC-CALIB	RED GREEN BLUE	000–255	Universal color calibration
SETTINGS	COLOR	OFF	Maximum output, unbalanced white
		RGBTOW	White output is determined by the CALIB > RGBTOW settings
		UC	Output matches that of product's previous versions
	RESET	NO	Resets unit to factory default settings
		YES	

DMX Configuration

Use control configurations to operate the product with a DMX controller.

Control Personalities

To set the control personality:

1. Go to the **PERSON** main level.
2. Select the desired personality, from **ARC1**, **ARC1+D**, **ARC2**, **ARC2+D**, **ARC FULL**, **SOLID**, **SPECIAL1**, or **SPECIAL2**.



- See the [Starting Address](#) section for the highest starting address that can be selected for each personality.
- Make sure that the starting addresses on the various products do not overlap due to the new personality setting.

Starting Address

Each product will respond to a unique starting address from the controller. All products with the same starting address will respond in unison. To set the starting address:

1. Go to the **DMX** main level.
2. Select the starting address (**001–512**).

Personality	Channels	Highest Address	Personality	Channels	Highest Address
ARC1	3	510	ARC FULL	8	505
ARC1+D	4	509	SOLID	1	512
ARC2	4	509	SPECIAL1	15	498
ARC2+D	5	508	SPECIAL2	9	504

Control Channel Assignments and Values

Preset Colors Chart

Value	Preset Color	Value	Preset Color	Value	Preset Color
000 ⇔ 010	No function	071 ⇔ 080	LEE Yellow	161 ⇔ 165	Dark Steel Blue
011 ⇔ 020	Light Salmon	081 ⇔ 085	Ice And A Slice	166 ⇔ 185	Pale Violet
021 ⇔ 025	Scarlet	086 ⇔ 110	Dark Yellow Green	186 ⇔ 200	Pretty 'n Pink
026 ⇔ 030	Flame Red	111 ⇔ 120	Turquoise	201 ⇔ 205	Follies Pink
031 ⇔ 045	Dark Salmon	121 ⇔ 140	Steel Green	206 ⇔ 220	Smokey Pink
046 ⇔ 050	Sunset Red	141 ⇔ 145	Steel Blue	221 ⇔ 225	Flesh Pink
051 ⇔ 060	CID (to Tungsten)	146 ⇔ 150	Special Steel Blue	226 ⇔ 240	Pink
061 ⇔ 065	Soft Golden Amber	151 ⇔ 160	New Color Blue	241 ⇔ 255	Cherry Rose
066 ⇔ 070	Urban Sodium				

Color Temperature Chart

Value	Temperature	Value	Temperature	Value	Temperature
000 ⇔ 009	No function	070 ⇔ 085	3200–4000K	145	6000K
010	1800K	085	4000K	145 ⇔ 160	6000–6500K
010 ⇔ 025	1800–2200K	085 ⇔ 100	4000–4500K	160	6500K
025	2200K	100	4500K	160 ⇔ 175	6500–7000K
025 ⇔ 040	2200–2700K	100 ⇔ 115	4500–5000K	175	7000K
040	2700K	115	5000K	175 ⇔ 190	7000–8000K
040 ⇔ 055	2700–3000K	115 ⇔ 130	5000–5600K	190	8000K
055	3000K	130	5600K	190 ⇔ 205	8000–10000K
055 ⇔ 070	3000–3200K	130 ⇔ 145	5600–6000K	205 ⇔ 255	10000K
070	3200K				

ARC

1	1+D	2	2+D	FULL	Function	Value	Percent/Setting
–	1	–	1	1	Dimmer	000 ⇔ 255	0–100%
1	2	1	2	2	Red	000 ⇔ 255	0–100%
2	3	2	3	3	Green	000 ⇔ 255	0–100%
3	4	3	4	4	Blue	000 ⇔ 255	0–100%
–	–	4	5	–	Lime	000 ⇔ 255	0–100%
–	–	–	–	5	Preset colors	000 ⇔ 255	See Preset Colors Chart
–	–	–	–	6	Color temperature	000 ⇔ 255	See Color Temperature Chart
–	–	–	–	7	Strobe	000 ⇔ 009 010 ⇔ 255	No function Strobe, slow to fast
–	–	–	–	8	Dimmer speed	000 ⇔ 009 010 ⇔ 029 030 ⇔ 069 070 ⇔ 129 130 ⇔ 189 190 ⇔ 255	No function Off DIM1 (Fastest) DIM2 DIM3 DIM4 (Slowest)

SOLID

Channel	Function	Value	Percent/Setting
1	Dimmer	000 ⇔ 255	All LEDs (0–100%)

SPECIAL

1	2	Function	Value	Percent/Setting
1	1	Dimmer	000 ⇔ 255	0–100%
–	2	Red	000 ⇔ 255	0–100%
–	3	Green	000 ⇔ 255	0–100%
–	4	Blue	000 ⇔ 255	0–100%
–	5	Lime	000 ⇔ 255	0–100%
–	6	Preset color	000 ⇔ 255	see Preset Colors Chart
–	7	Color temperature	000 ⇔ 255	see Color Temperature Chart
2	8	Strobe	000 ⇔ 009 010 ⇔ 255	No function Strobe, 1–25 Hz
3	9	Dimmer speed	000 ⇔ 009 010 ⇔ 029 030 ⇔ 069 070 ⇔ 129 130 ⇔ 189 190 ⇔ 255	No function Dimmer speed OFF Dimmer speed 1 (fastest) Dimmer speed 2 Dimmer speed 3 Dimmer speed 4 (slowest)
4	–	Red 1	000 ⇔ 255	0–100%
5	–	Green 1	000 ⇔ 255	0–100%
6	–	Blue 1	000 ⇔ 255	0–100%
7	–	Lime 1	000 ⇔ 255	0–100%
8	–	Red 2	000 ⇔ 255	0–100%
9	–	Green 2	000 ⇔ 255	0–100%
10	–	Blue 2	000 ⇔ 255	0–100%
11	–	Lime 2	000 ⇔ 255	0–100%
12	–	Red 3	000 ⇔ 255	0–100%
13	–	Green 3	000 ⇔ 255	0–100%
14	–	Blue 3	000 ⇔ 255	0–100%
15	–	Lime 3	000 ⇔ 255	0–100%

Static Mode Configuration

To set the Illumipanel ML to operate in a static or strobing color without DMX:

1. Go to the **STATIC** main level.
2. Select the parameter to configure, from:
 - **RED**,
 - **GREEN**,
 - **BLUE**,
 - **COOL** (lime),
 - **SOLID** (no function), or
 - **STROBE**
3. Set the selected parameter to the desired level, from **000–255**.
4. Repeat until the static mode is set as desired.

Settings Configuration

Dimmer Speed

To set the dimmer speed:

1. Go to the **DIMMER** main level.
2. Select the dimmer speed from **OFF** (linear dimmer), **DIM1** (fastest), **DIM2**, **DIM3**, or **DIM4** (slowest).

Color Calibration

There are 4 color calibration options for the Illumipanel ML: **OFF** (maximum output/unbalanced white), **RGBTOW** (quad-color calibration), **UC** ("universal", tri-color calibration to match legacy products), and the color macro **WHITE 1–11** settings.

To select the color calibration mode:

1. Go to the **SETTINGS** main level.
2. Select the **COLOR** option.
3. Select the calibration mode, from **OFF**, **RGBTOW**, or **UC**.

Color Macro White Balance

To adjust the color macro white balance:

1. Go to the **CALIB** main level.
2. Select the macro to adjust, from **WHITE 1–11**.
3. Select the color level to adjust, from **RED**, **GREEN**, **BLUE**, or **COOL** (lime).
4. Set the level of the selected color, from **000–255**.
5. Repeat until the white balances are set as desired.

RGBTOW Mode

To adjust the color calibration in **RGBTOW** mode:

1. Go to the **CALIB** main level.
2. Select the **RGBTOW** option.
3. Select the color level to adjust, from **RED**, **GREEN**, **BLUE**, or **COOL** (lime).
4. Set the level of the selected color, from **000–255**.
5. Repeat until the calibration is set as desired.

Universal Calibration

To adjust the color calibration in **UC** mode:

1. Go to the **UC-CALIB** main level.
2. Select the color level to adjust, from **RED**, **GREEN**, or **BLUE**.
3. Set the level of the selected color, from **000–255**.
4. Repeat until the calibration is set as desired.

Factory Reset

To reset the product to factory default settings:

1. Go to the **SETTINGS** main level.
2. Select the **RESET** option.
3. Select from **NO** (cancel) or **YES** (reset).

5. Maintenance

Product Maintenance

Dust build-up reduces light output performance and can cause overheating. This can lead to reduction of the light source's life and/or mechanical wear. To maintain optimum performance and minimize wear, clean lighting products at least twice a month. However, be aware that usage and environmental conditions could be contributing factors to increase the cleaning frequency.

To clean the product, follow the instructions below:

1. Unplug the product from power.
2. Wait until the product is at room temperature.
3. Use a vacuum (or dry compressed air) and a soft brush to remove dust collected on the external surface/vents.
4. Clean all transparent surfaces with a mild soap solution, ammonia-free glass cleaner, or isopropyl alcohol.
5. Apply the solution directly to a soft, lint free cotton cloth or a lens cleaning tissue.
6. Softly drag any dirt or grime to the outside of the transparent surface.
7. Gently polish the transparent surfaces until they are free of haze and lint.



Always dry the transparent surfaces carefully after cleaning them.

6. Technical Specifications

Dimensions and Weight

Length	Width	Height	Weight
20.9 in (530 mm)	7.9 in (200 mm)	10.1 in (256 mm)	27.6 lb (12.6 kg)

Note: Dimensions in inches are rounded.

Power

Power Supply Type		Range			Voltage Selection	
Switching (internal)		100 to 277 VAC, 50/60 Hz			Auto-ranging	
Parameter	100 V, PF: 99	120 V, PF: 98	208 V, PF: 91	230 V, PF: 90	240 V, PF: 88	277 V, PF: 79
Consumption	187 W	184 W	178 W	177 W	175 W	177 W
Operating current	1.88 A	1.54 A	0.93 A	0.84 A	0.81 A	0.79 A
Power I/O		U.S./Worldwide			UK/Europe	
Power input connector		Bare-ended power input cord			Bare-ended power input cord	
Power Connection				Recommended Power Cable		
6.25 ft (1.9 m) waterproof cable				14 AWG (3 x 2.08 mm ²)		

Light Source

Type	Color	Quantity	Power	Current	Lifespan
LED	Quad-color RGLB	12	20 W	1 A	50,000 hours

Photometrics

Parameter	Installed Optics (6°)	Medium Filter	Wide Filter	Very Wide Filter	Asymmetrical Filter
Beam Angle	6.5°	19.7°	32.8°	33.5°	34.9° x 11.8°
Field Angle	11.6°	41.1°	65.7°	73.6°	66° x 28.5°
Cutoff Angle	19.9°	61.5°	162.1°	168.7°	162.4° x 51.2°
Lumens	7,045	6,022	5,086	5,006	5,884
Illuminance @ 5 m	10,926 lux	1,244 lux	350 lux	266 lux	967 lux
Efficacy @ Full			Color Temperature Presets		
38 lm/W			1800–10000K		

Thermal

Startup Temperature Range	Operating Temperature Range	Cooling System
-4 °F–113 °F (-20 °C–45 °C)	-40 °F–113 °F (-40 °C–45 °C)	Convection

DMX

I/O Connector	Channel Range
USITT DMX-512a	1, 3, 4, 5, 8, or 9 channels

Ordering

Product Name	Item Name	Item Code	UPC Number
Illumipanel ML	ILUMIPANELML	01621635	781462219833



RoHS



Contact Us

General Information	Technical Support
Chauvet World Headquarters	
Address: 3360 Davie Rd., Suite 509 Davie, FL 33314 Voice: (954) 577-4455 Fax: (954) 929-5560 Toll Free: (800) 762-1084	Voice: (844) 393-7575 Fax: (954) 756-8015 Email: support@iluminarc.com Website: www.iluminarc.com
Chauvet U.K.	
Address: Pod 1 EVO Park Little Oak Drive, Sherwood Park Nottinghamshire, NG15 0EB UK Voice: +44 (0) 1773 511115 Fax: +44 (0) 1773 511110	Email: UKtech@chauvetlighting.eu Website: www.iluminarc.com
Chauvet Benelux	
Address: Vaartlaan 9 9800 Deinze Belgium Voice: +32 9 388 93 97	Email: BNLtech@chauvetlighting.eu Website: www.iluminarc.com
Chauvet France	
Address: 3, Rue Ampère 91380 Chilly-Mazarin France Voice: +33 1 78 85 33 59	Email: FRtech@chauvetlighting.fr Website: www.iluminarc.com
Chauvet Germany	
Address: Bruno-Bürger-Str. 11 28759 Bremen Germany Voice: +49 421 62 60 20	Email: DEtech@chauvetlighting.de Website: www.iluminarc.com
Chauvet Mexico	
Address: Av. de las Partidas 34 - 3B (Entrance by Calle 2) Zona Industrial Lerma Lerma, Edo. de México, CP 52000 Voice: +52 (728) 690-2010	Email: servicio@chauvet.com.mx Website: www.iluminarc.com

Warranty & Returns

For warranty terms and conditions and return information, please visit our website.

For customers in the United States and Mexico: www.chauvetlighting.com/warranty-registration.

For customers in the United Kingdom, Republic of Ireland, Belgium, the Netherlands, Luxembourg, France, and Germany: www.chauvetlighting.eu/warranty-registration.